

# KZP WALL PLATE SOCKETS

## KZP 08, 06, 04, 02

2-OUTPUTS OUTLET SOCKET

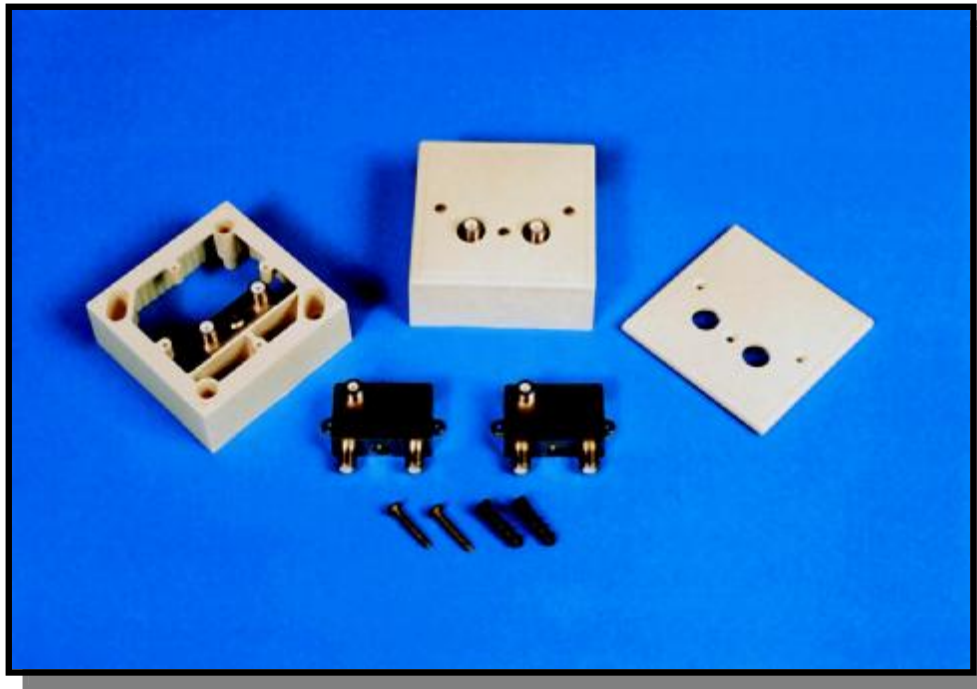

Featuring :

- High RFI shielding
- “F” connectors on Inputs and Outputs
- Mounting is compatible with wallplates made by Bosch, Teleste, Kathrein and others
- Superior specifications
- Simple installation
- Unique size and shape of the socket and cover plate allowing the tap to be mounted either to the plastic box, or to the cover plate



KZP wall plate sockets are suitable for CATV subscriber network. KZPs are used as terminating outlets in the subscriber network. All tap ports are terminated by “F” connectors. The complete wallplate kit includes KZP tap, plastic cover plate, plastic wall box , 2 screws and 2 feed through bushings to place the plastic box on the wall. The cover plate has two marked holes TV and R to connect white fly leads.

## Technical Specifications

RF Shielding at bandwidth 5-862 MHz  $A_t \geq 100$  dB

Parameter	Frequency (MHz)	Model			
		KZP 08	KZP 06	KZP 04	KZP 02
<b>Insertion Loss [dB]</b>					
Input to TV	5 - 47	8.0	6.5	4.0	2.0
	47 - 550	8.0	6.5	4.0	2.0
	550 - 862	8.0	6.5	4.5	2.0
Input to R	87.5 - 139	9.0	10.0	8.5	6.0
<b>Isolation [dB]</b>					
TV-R	5 - 862	$\geq 36$	$\geq 36$	$\geq 36$	$\geq 32$
<b>Return Loss [dB]</b>					
TV	5 - 47	$\geq 14$	$\geq 14$	$\geq 14$	$\geq 13$
	47 - 862	$\geq 14^*$	$\geq 14^*$	$\geq 14^*$	$\geq 13^*$
R	87.5 - 139	$\geq 14$	$\geq 14$	$> 10$	$> 9$
Input <sup>A</sup>	5 - 47	$\geq 18$	$\geq 18$	$\geq 16$	$\geq 14$
	47 - 862	$\geq 18^*$	$\geq 18^*$	$\geq 14^*$	$\geq 14^*$
Input <sup>B</sup>	5 - 862	$\geq 10$	$\geq 10$	$\geq 8$	$\geq 4$

\* -1.5 dB/oct.

<sup>A</sup> (terminated TV and R ports)

<sup>B</sup> (non - terminated R port)

R output frequency bandwidth is manufactured as standard or to customer specification.

# KZP 06 DTVR

## 3-OUTPUTS MULTI-MEDIA OUTLET BOX

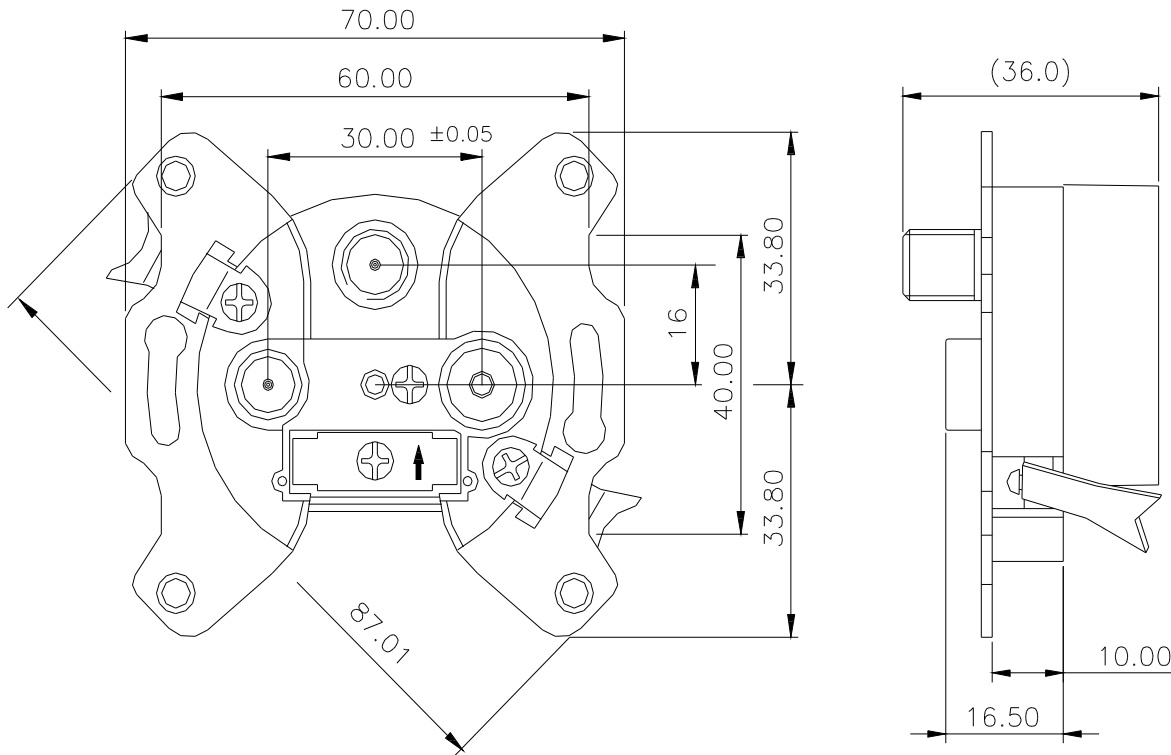

### Mechanical specification:

1	Housing	Material : Zinc Die-casting	Finishing : Nickel Plated
2	Connectors	IN :	Terminal Block
		DATA :	"F" Female, Isolator : PE
		TV :	"IEC" Male connectors according to IEC 169-2
		R :	"IEC" Female connectors according to IEC 169-2
3	Weight	110 g	

**Technical specification:**

Item	Description		Freq. Range ( MHz )	Specifications
1	Insertion Loss (dB)	IN - DATA	5 ~ 550	8.5 typ. 9 max.
			550 ~ 860	9 typ. 10 max.
			860 ~ 1000	9.5 typ. 10.5 max.
		IN - TV	5 ~ 65	60 typ. 50 min.
			87.5 ~ 108	30 typ. 22 min.
			120 ~ 125	7 typ. 8 max.
			125 ~ 860	6.5 typ. 7.5 max.
			860 ~ 1000	6 typ. 7 max.
			IN - RADIO	5 ~ 65
		87.5 ~ 108		7.5 typ. 8.5 max.
		120 ~ 1000		30 typ. 22 min.
		TV - RADIO	5 ~ 68	60 min.
87.5 ~ 108	20 min.			
120 ~ 1000	20 min.			
2	Isolation (dB)	DATA - TV	5 ~ 65	70 typ. 60 min.
			65 ~ 300	25 min.
			300 ~ 860	22 min.
			860 ~ 1000	20 min.
		DATA - R	5 ~ 65	60 typ. 45 min.
			65 ~ 300	25 min.
			300 ~ 860	22 min.
			860 ~ 1000	22 min.
3	Return Loss (dB)	IN	5 ~ 65	20 typ. 16 min.
			87.5 ~ 108	18 typ. 14 min.
			120 ~ 1000	18 *
		DATA	5 ~ 65	14 min.
			65 ~ 1000	18 *
		TV	120 ~ 1000	14 *, but • 10
		RADIO	87.5 ~ 108	10 min.
		IN	5 ~ 1000	10 min. (DATA, TV, FM unterminated )
4	Impedance			75 Ω

\* at 40 MHz -1.5 dB/ Oct.

# KZP 06 DTVR-F

## 3-3-OUTPUTS MULTI-MEDIA OUTLET BOX

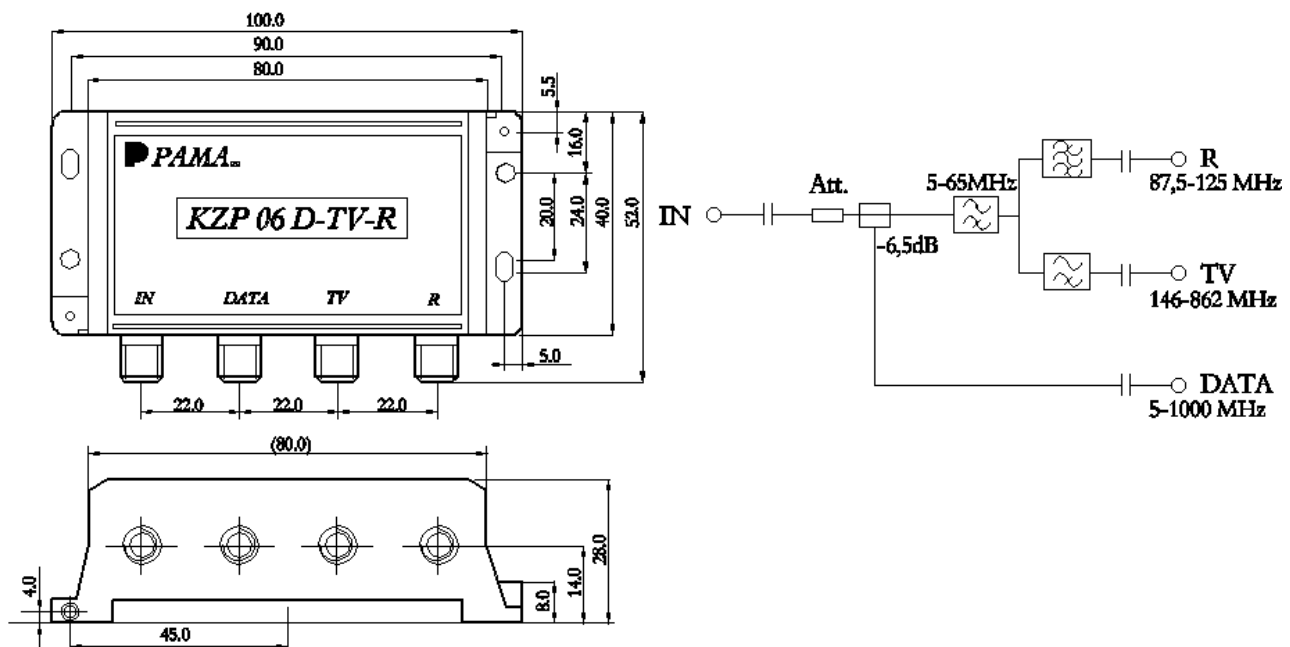

### Mechanical specification:

- Housing: material from Zinc Die-casting  
finishing: plated nickel
- Connectors: "F" Female  
PE Isolation



**Technical specification:**

FREQ. RANGE		5 - 1000 MHz	
INSERTION LOSS	IN - TV	5 - 65 MHz	40 dB
		146 - 862 MHz	6,5 ± 1 dB
	IN - FM	5 - 65 MHz	20 dB min.
		87,5 - 125 MHz	6,5 ± 1 dB
		146 - 1000 MHz	20 dB min.
IN - DATA	5 - 1000 MHz	11 ± 1 dB	
ISOLATION	TV - FM	87,5 - 125 MHz	25 dB typ. / 20 dB min.
		146 - 862 MHz	25 dB typ. / 20 dB min.
	TV - DATA	5 - 65 MHz	55 dB typ. / 50 dB min.
		147 - 1000 MHz	30 dB typ. / 20 dB min.
	DATA - FM	5 - 65 MHz	55 dB typ. / 50 dB min.
		87,5 - 1000 MHz	30 dB typ. / 20 dB min.
RETURN LOSS	IN	5 - 40 MHz	22 dB min.
		40 - 1000 MHz	22 dB* min.
	TV	146 - 862 MHz	(T) 18 dB* min    (U) 14*min. but ≥ 10 dB
	FM	87,5 - 125 MHz	(T) 18 dB* min    (U) 14*min.
	DATA	5 - 1000 MHz	(T) 18 dB* min    (U) 14*min. but ≥ 10 dB
CONNECTORS	ALL PORTS	"F" Female	
IMPEDANCE		75 Ohms	

Note: \* = 40 MHz - 1,5 dB/ oct.

T = terminated output

U = unterminated output

**PAMA, spol. s r.o.**

Letenská 1918

756 61 Rožnov pod Radhoštěm

Czech Republic

phone: +420-571654130, fax: +420-571654133

e-mail: [pama@pamacorp.com](mailto:pama@pamacorp.com)

<http://www.pamacorp.com>